

NO	QTY	PART NO	DESCRIPTION	STD SEAL KIT
1	2	21500018	SCREW, CAP, SOCH, M3 X 5, ALY	
2	2	21500200	WASHER	
3	1	39010021	SEAL, LL, (3/4 X 1/8 X 1/8 X 1)	X
4	1	39011030	SEAL, CROWN, 1-1/16x1-1/4x5/32	X
5	2	39050042	O-RING, (-011)	X
6	1	39051073	O-RING, (-124)	X
7	2	43068006	PLUG, PORT, HOLLOW HEX, G1/4	
8	1	48211014	PISTON, CYL, BB, COMBO, 27,7 KN, 25	
9	1	48211022	GLAND, CYL, BB, COMBO, 27,7 KN	
10	1	39V10022	WIPER, PRESS-IN, (3/4)	X
N/A	N/A	60211202	KIT, SEAL, CYL, BB, COMBO, DA, 27.7 KN	NOTED

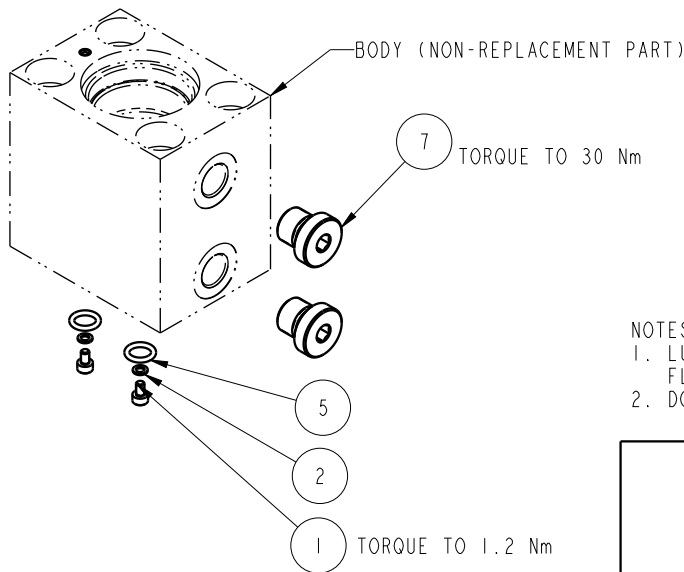

- NOTES:
- LUBRICATE ALL SEALS WITH CLEAN HYDRAULIC FLUID PRIOR TO INSTALLATION.
 - DO NOT USE SILICONE TYPE LUBRICANTS.

PARTS LIST

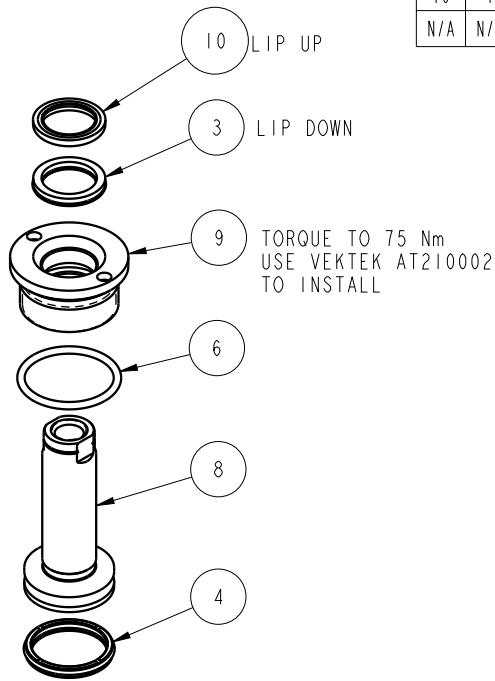

VEKTEK, INC.
1334 E. SIXTH AVE. P.O. BOX 625
EMPORIA, KS. 66801 U.S.A.

ASSEMBLIES AFFECTED

PARTS LIST, CYL, BB, COMBO, DA, 27.7 KN, 25

42112104

L2112104

SIZE
A

MPLV4204

REV
D

D	4246	RELEASE	MJUST	8/4/20
REV	IN ACCORDANCE WITH ECN	EFFECTIVE DATE	REVISED BY	DATE
DRW BY:	K. ROEMER	DRAWING STATUS: Released		
DATE:	11/09/11	PRODUCTION APPROVED FOR RELEASED STATUS ONLY		

FORM FEG035_PL_ASIZE, REV. B

SHEET 1 OF 1